

2016 MULE PRO-DX EPS

Diesel Mule: Most Dependable Workhorse

Like the PRO FXT petrol model counterpart the three-seater PRO-DX EPS offers Diesel economy, Durability and Comfort and Convenience. The diesel model was designed primarily for work applications, where their high-torque diesel engine will deliver excellent performance and allow on-site fuel compatibility. With a greater focus on cargo carrying performance, the PRO-DX EPS features a long, flat cargo bed the largest in the MULE fleet, making it the workhorse of choice for customers who need to haul material.



The Mule PRO-DX's combination of Diesel economy, durability, comfort and convenience make it the industry's most dependable outdoor partner. The PRO-DX features Electric Power Steering, seats up to three adults with a ROPS approved Cab Frame for added peace of mind.

* Terms & Conditions Available from Kawasaki Mule / Teryx Dealerships

Engine:	
Type	Liquid-cooled, 4-stroke, 3-cylinder, Diesel OHV
Displacement	993 cm ³
Bore and Stroke	74.0 x 77.0 mm
Compression ratio	23.5:1
Combustion chamber	Swirl chamber
Fuel system	In-line injection pump
Starting	Electric
Lubrication	Forced lubrication, wet sump
Drivetrain:	
Transmission	Dual Range (high/low) CVT with reverse
Primary Drive	Belt Converter
Final Drive	2WD/4WD shaft Dual-Mode Differential
Primary reduction ratio	3.334 - 0.756 (belt converter)
Gear Ratios:	
Foward (High)	1.952 (34/33 x 36/19)
Forward (Low)	3.876 (45/22 x 36/19)
Reverse	3.009 (27/17 x 36/11)
Final reduction ratio Front	6.382 (31/17 x 35/10)
Final Reduction ratio Rear	6.245 (31/21 x 55/13)
Frame:	
Type	Ladder type, tubular steel
Wheel travel:	
Front	222 mm
Rear (left, right)	217mm, 220mm
Tyre:	
Front	26 x 9.00-12 4PR
Rear	26 x 11.0-12 4PR
Caster (rake)	4.4°
Track (front / rear)	1,385 mm / 1,315 mm
Steering angle (left/right)	40°(IN) / 31° (OUT), 40° (IN) / 31° (OUT)

Suspension:	
Front	Double Wishbone
Rear	Double Wishbone
Brakes:	
Front:	Dual 212 mm discs with two-piston calipers
Rear:	Dual 212 mm discs with single-piston calipers
Parking Brake:	Dual Disc (mechanical)
Dimensions:	
Overall length	3,385 mm
Overall width	1,625 mm
Overall height	1,965 mm
Wheelbase	2,345 mm
Ground clearance	265 mm
Seat height	885 mm
Curb mass	826 kg (includes full tank of fuel and all liquids at optimum levels)
Dry Weight	791 kg
Fuel capacity	30.0 L
Performance:	
Maximum Power	17.8kW {24PS} / 3,600 rpm
Maximum Torque	52.1 N.m {5.3kgf.m} / 2,400 rpm
Minimum Turning Radius	4.8m
Cargo Bed Capacity	453 kg
Cargo Box (inside) L x W x H	1,375 x 1,355 x 280 mm
Seating Capacity	3 person
Max. Permissible Load	733kg
Max Towing Capacity	907kg
Warranty:	
	3 year warranty ? Terms & Conditions Apply ? Discuss with a Kawasaki Dealer
Colours:	
	Timberline Green



The specifications mentioned here apply to and have been achieved by production models under standard operating conditions. We intend only to give a fair description of the vehicle and its performance capabilities but these specifications may not apply to every machine supplied for sale. Kawasaki Heavy Industries, Ltd. and Kawasaki Motors Pty Ltd reserve the right to alter the specifications without prior notice. Equipment illustrated and specifications may vary to meet individual markets.



Seating for THREE adults with largest cargo bed in class

If cargo capacity is your greatest priority, then the MULE PRO-DX is your partner of choice. Its cargo bed is the largest in its class, ensuring you can carry more, and carry it more easily.



Cargo bed dimensions are 1,375 mm L x 1,355 mm W x 280 mm H. Its long, flat design makes it easy to load from three sides. Cargo bed load capacity is 453 kg.



Powerful Engine: Inline Triple

Enabling fuel compatibility amongst workplace machines, the MULE PRO-DX is well suited for use in working environments where diesel is the primary fuel, such as in agriculture, underground mining, inside factories or on military bases and construction sites.

Combined with their rugged chassis, these hardy machines also represent practical choices for more traditional utility vehicle users who simply wish to opt for the lower operating costs, durability and reliability that a diesel-powered vehicle offers. Whether for industrial or general usage, the diesel MULE meet the needs of a broad range of utility vehicle customers.

30 Litre Fuel Tank

The large 30 litre fuel tank enables long intervals between fill-ups on work sites.

Hydraulic Disc Brakes

Front and rear disc brakes ensure strong, sure stopping power. The hydraulic disc system offers predictable performance, delivering brake power that matches input at the brake pedal.



Front Discs are 212mm and gripped by two-piston (27mm) calipers.



Rear Discs are 212mm with single 34mm piston caliper. Semi-metallic brake pads offer the right balance between braking power and long life.

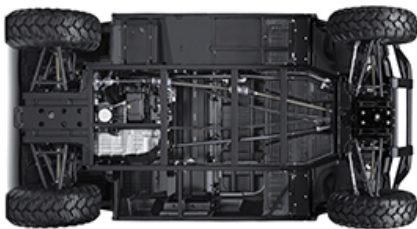

Durability

Kawasaki MULE side by sides are famous for their durability, and the MULE PRO-DX is no exception. Built to last, the newest additions to Kawasaki's MULE PRO Series line-up also look tough thanks to their rugged, no-nonsense styling.

After undergoing extensive stiffness balance testing, the frame offers good lateral and torsional stiffness. The right amount of chassis flex to handle the shock of off-road work while maintaining a high level of ride comfort.

ROPS approved cab frame and inertia reel seat belts are standard for added peace of mind. Always wear an approved helmet and read the owners manuals.

Stable Wide-body Chassis

The MULE PRO-DX combine a wide-body chassis with a 2,345 mm wheelbase. This contributes to riding stability and comfort, while offering easy operability and manoeuvrability.

Wide track: 1,385 mm (front), 1,315 mm (rear)) contributes to vehicle stability. The stable chassis platform is complemented by front and rear independent suspension that adds to ride comfort.

Wheelbase of 2,345 mm enables a relatively short 4.8 m turning radius, which facilitates negotiating tight corners in the bush or on trail courses.

The wheelbase and ground clearance: 265 mm result in a favourable breakover angle: 26°, which reduces the chance of bottoming out when cresting a ridge or riding over a fallen log. High approach and departure angles : 78° and 64° also contribute to off-road performance. Minimising bodywork overhang reduces the chance of hitting the bumper or scraping the tail when going up or coming down steep slopes.



Simple, Rugged Styling

Designed to reflect the tough construction and strong performance, the MULE PRO-DX EPS features rugged, no-nonsense styling similar to that found on hard working utility vehicles.

Clean Dashboard Design

Clean dashboard design includes switches for the lights, selectable 4WD, rear differential lock. Cup holders and 3 handy storage compartments right, left and centre, also handy five spaces for additional switches have been prepared.



Bright Headlights and Large Tyres

Dual 55/60W headlights cut a bright path through the dark for clear visibility on night rides.

Optional Accessory LED headlights are available for the PRO-DX EPS model, for more lighting power.

The MULE PRO-DX EPS is equipped with 26" tyres on 12" rims. The large 26" radial tyres easily overcome obstacles and contribute to the PRO-DX's excellent off road handling.



Comfort & Convenience

Complementing the superb outdoor performance MULE PRO-DX, and Kawasaki's famous durability, these models also offer a number of comfort and convenience features to ensure that passengers are able to relax and enjoy the ride.

Doors Standard

Doors are a standard feature on all PRO-DX model, contributing to enhanced comfort and convenience.

The PRO-DX comes standard with doors, offering a level of mud protection and helping to prevent branches, gravel and other debris from getting inside the passenger compartment, while facilitating getting in and out of the vehicle.

Simple latch mechanism facilitates opening and closing the doors.



Digital Instrumentation

Multi function display built into the dash is standard on the PRO-DX EPS. Features include:

- Digital speedometer
- Digital fuel gauge
- Odometer
- Hour meter
- Clock
- Dual trip meters
- 2WD / 4WD indicator
- Parking indicator
- Water temperature warning indicator
- Fuel injection warning indicator
- CVT warning light
- EPS warning light
- Neutral indicator light
- Reverse indicator light
- Oil pressure warning light

DC Sockets

Two DC sockets are integrated into the dashboard provide power supply (up to 120W) for accessory items or personal device charging.



Roomy Interior

The wide-body chassis of the MULE PRO-DX enables a roomy interior space that offers the shoulder and legroom for three adults to comfortably sit side-by-side.

Seat material has superb elasticity, offering increased comfort and holding performance. The material is also resistant to cold, allowing it to maintain its suppleness when temperatures drop and reducing the chance of tearing/ripping when exposed to cold temperatures. Handgrips for the passengers (integrated into the ROPS frame) contribute to comfort. Each seating position is equipped with a three-point seat belt to ensure driver and passengers stay securely in place.



Steering

Steering wheel has a stepless range of approximately 40° allowing drivers to set the position to suit personal preference. This can also be used to lift the steering wheel out of the way to facilitate getting in and out of the vehicle. The thickly cushioned steering wheel contributes to comfort as well as the high quality feel of the PRO-DX.

Electric Power Steering (EPS)

Kawasaki's high grade electric power steering (EPS) system works best when you need it most: at extreme slow speed and when stopped. turning the wheel causes a signal to be sent to the EPS ECU, initiating assistance. At slow speed or when stopped, assistance is greatest; assistance is reduced as vehicle speed increases to ensure stable handling. The EPS system also enhances the ride comfort and control by acting as a damping system.

The electric system works immediately, without time lag, when the engine is first started. The EPS system does not rely on an oil pump, therefore there is no engine power loss and fuel efficiency is uncompromised.

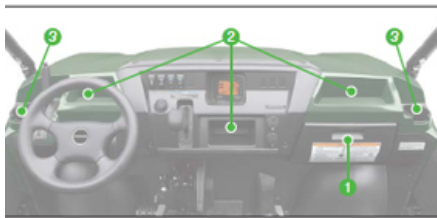

Handy Storage

Passenger side glove box provides enclosed storage for small items. Three dashboard pockets (left, centre, right) provide a handy place to put small items. The centre pocket is large enough to accommodate the accessory audio system.

Two drink holders are built into the bodywork of the front dashboard. An optional accessory bin can be fitted under the front bench seat for convenient covered storage.



2WD /

4WD Easy Change

Electrically selectable 2WD / 4WD and dual-mode rear differential system to allow easy changing between drive systems to suit changing terrain and applications.

Flipping the switches causes the systems to engage instantly, ensuring the rider has full control of when 4WD or the rear differential lock is activated.

Dual-mode rear differential provides maximum traction when in locked mode and minimises ground clearance when unlocked.

Numerous Genuine Accessories

Talk to your local Kawasaki dealership about your needs. The PRO-DX EPS comes standard with doors

- Accessory Mounts
- Accessory Fuse Kit
- Half/Full windshield
- Horn Kit
- Cab Enclosed Hard
- Hard Roof
- Back-up beeper
- Skid Plates
- CV Guards
- LED Lightbar
- LED Headlights
- Tail light guards
- Rear Bumper
- Hitch drawbar
- Rifle case mount
- Gun Boot
- Hydraulic Bed Lift Kit
- Cargo box
- Cargo Mat
- Floor Mats Front and Rear
- Winch Mount Kit
- Winches
- Centre Console
- Click on the Genuine Accessories tab for more information

Accessories for KAF1000EGF 2016 MULE PRO-DX DIESEL (2743)



BACK-UP BEEPER

Whether on the job site or the farm, a Back-up Beeper is a necessary and often required addition to alert others that your vehicle is reversing. Important Notes: wires directly to the reverse switch on the transmission.



BRUSH GUARD

Add protection and aggressive style to the front of your vehicle with this durable laser cut, formed steel brush guard. Powder coated in textured black to match the stock front bumper for a uniform look. Built-in headlight guards and mounting tabs for the Kawasaki Genuine LED lighting Kit, provide additional versatility as well as saving you money when compared to purchasing these items separately.



CARGO BED LIFT - HYDRAULIC

Raise and lower your cargo bed with a Hydraulic Cargo Bed Lift, saving energy and increasing productivity. Featuring "earth mover" grade lifting power in a self-contained hydraulic system for a product you can count on each and every workday -- no hoses, no reservoir to fill or top off, no bleeding process.



CARGO DIVIDER

Roto molded PE plastic panel designed to fit perfectly in the slots of the MULE PRO-FXT bed sides in multiple configurations Kit includes one panel that divides the bed into two sections for convenient loading Additional kits can be added to further divide the cargo bed



CARGO MAT

Protect your cargo bed base with this tough 3/16" extra thick rubber mat Extra thick rubber helps prevent cargo from sliding Reduces sound levels caused from vibration 3/16" thick black molded rubber



CENTER CONSOLE

Safely store small tools, important documents and any additional items in this durable water resistant Center Console. Hinged lid locks into place when closed and is covered with a 750mm thick foam pad for diiver and passenger comfort. Attaches quickly and easily to the front bench seat in the centre passenger position with provided shock cords. IMPORTANT NOTES: Front seat application only.



CLEANER WIPE DOWN

* High gloss formula specifically developed for the Powersports industry * Wipe down cleaner coats plastic, fiberglass and painted surfaces * Restores showroom shine in a few quick wipes * Makes cleaning process fast, simple and effortless * Leaves a clear coat film for extended protection against the elements * 12 US FLOZ (355mL)



COOLANT ALUMA-COOL

* Full strength engine coolant (not pre-diluted) * T-Triazole for maximum corrosion protection in aluminium cooling systems * Contains foam and rust inhibitors



DETAILER WAX AND SHINE

* The All-In-One Detailer that cleans shines and protects all painted surfaces, chrome parts, windshields and plastics * Carnauba wax formulation provides a deep show-like shine making your vehicles painted surfaces come to life * Easy spray applicator * 12 US FLOZ (355mL)



FLOOR MATS - FRONT

Protect your feet and floorboards with these tough 187mm extra thick rubber mats. Each mat has been modded for a perfect fit and mounts directly to the floorboard to help prevent movement. The extra thick rubber also reduces sound levels caused from vibration.



FLUID BRAKE DOT 3&4

* Performs consistently over a broad range of temperatures * Meets all DOT 3/4 specs for universal application

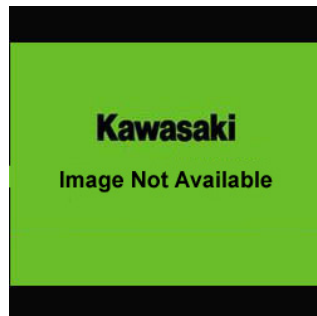

FRONT ACCESSORY HARNESS

Front Accessory Harness.

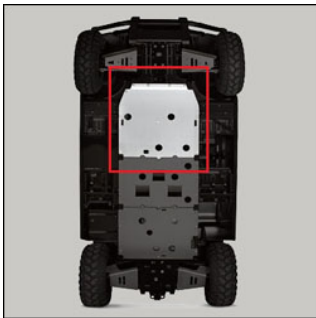

FRONT SKID PLATE

Protect your drive chain and chassis with a durable brushed aluminium Kawasaki Genuine Skid Plate. Unlike the aftermarket plate, each Genuine plate has been designed with precise ventilation holes and has been tested to prevent high engine temps during hard use or hot weather.



GREASE MULTIPURPOSE

* Multi-purpose extreme pressure, lithium complex grease which imparts superior high and low temperature characteristics and chemical stability * High tensile strength provides durability under heavy loads, resists mechanical breakdown and water "wash-out" * Offers excellent rust & oxidation protection and is highly compatible with seals * 16 OZ (454g)



GUARD - REAR CV JOINT

While operating your vehicle in rough terrain these lightweight CV Joint Guards protect your rear a-arms, axles, brake-lines and CV Boots. In addition to protection, the full-coverage design adds a custom look to your vehicle.

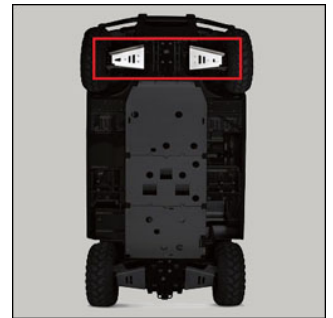

GUARDS - FRONT CV JOINT

While operating your vehicle in rough terrain these lightweight CV Joint Guards protect your front a-arms, axles, brake-lines and CV Boots. In addition to protection, the full-coverage design adds a custom look to your vehicle.



HORN

Install a horn to alert others of your presence while on the job site or the trail. Internally Mounted. (INCLUDES: WIRING HARNESS AND SWITCH).



KOLPIN GUN BOOT 6.0 TRANSPORT

Securely transport and conveniently store your rifle with the Kolpin Gun Boot 6.0 Transport case. Extra-large interior features two layers of dense closed cell foam for protection and is roomy enough to accommodate a variety of fire-arms, including: rifles up to 129.54cm in total length, scopes up to 60mm, pistol grip type rifles and left and right hand bolt action weapons.



KQR CARGO BED EXTENDER

Extend your usable cargo space by 8" with this durable roto-molded plastic Bed Extender. Simply lower the tailgate and attach the extender to the bed rails with two KQR Clamps. Easily adjust to different cargo sizes by sliding the clamps forward or backward or by reversing the entire Bed Extender to create a divider. Two Kawasaki Quick Release Clamps included.



KQR - CARGO BOX

Add secure storage within your vehicle's cargo bed in seconds. The KQR Cargo Box utilizes two KQR Accessories mounts KAF080-012 (Sold Separately) to quickly attach to either cargo bed rail. Ample internal dimensions provide plenty of storage space for transporting tools, equipment, straps, Tie-downs, emergency kits, or trail snacks. Important Notes: Requires 2 KQR Accessories Mounts KAF080-012.



KQR ACCESSORIES MOUNT

Required for quick-mounting the KQR Cargo Box and KQR Gun Boot Mount to the vehicle bed and rear cab rails. - Constructed of black anodized aluminum for durability - Mounts are sold individually - Refer to each KQR accessory for the quantity of mounts required



KQR PLASTIC FULL WINDSHIELD

Made from scratch-resistant polycarbonate, the KQR Full Windshield provides wind and debris protection for improved in-cabin comfort. With the added KQR installation system, once installed, you can quickly install and remove the windshield without the use of tools.



KQR PLASTIC WINDSHIELD - HALF

Deflect direct wind blasts while maintaining comfortable air-flow throughout cabin with this KQR installation system, once installed, you can quickly install and remove the windshield without the use of tools.



KQR RIFLE CASE MOUNT

The KQR Rifle Case Mount allows for secure, convenient weapon storage within the bed of your vehicle. Plus our KQR installation system allows you to quickly add or remove mounts as needed. For the Mule Pro-FXT, a total of six rifles can be installed while vehicle is in 3-passenger mode and three rifles while in 6-passenger mode.



LED - DOME LIGHT

Front and rear LED Dome Lights illuminate the interior of your vehicles cabin for increased visibility while reading a map or organising your belongings. Battery operated design allow for a quick, wireless installation in the overhead console of your Hard Cab Enclosure. Purchase as an optional accessory of the Kawasaki Genuine Hard Cab Enclosure.



LED LIGHTBAR

Work or play, some things need to get done after the sun goes down. This premium LED Lightbar mounts to the front of your vehicles accessory Brush Guard and puts out 2,200 lumens in a wide beam flood pattern. (NOTE THIS PART REQUIRES THE FOLLOWING PARTS). LED Lightbar Harness Kit KAF080-020: Fuse Box KAF080-042 and Brush Guard 99994-0412.

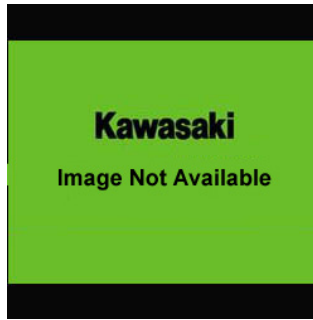

LED LIGHTBAR HARNESS KIT

A required component of the LED lightbar. This kit includes the primary LED Lightbar wiring harness and dash-mounted on/off switch.



PLASTIC ROOF

This semi-rigid Plastic Roof helps offer passenger protection from harsh weather and sun Contoured lightweight design for added style Made from semi-rigid black textured plastic Can use alone or with Kawasaki Genuine Accessory KQR? Half Windshield or KQR? Full Windshield - Plastic Original equipment on LE models Caution: An enclosed trailer is recommended when transporting a vehicle with a Plastic Roof installed



PREWASH - ON AND OFF ROAD

* Unique formula breakdown dirt, grime and oils while gently protecting paint and other delicate finishes * Safe on plastics, carbon fiber, paint, anodizing, aluminum, titanium, rubber * Biodegradable cleaning formula * Contains no harmful acids, CFC's or solvents * Will not harm seals or brake pads * Spray on, wash off, go ride * 32 US FLOZ (946mL)



Rear Bumper

This stylish yet functional accessory helps protect the rear of your vehicle from unintended impact while backing-up or loading your cargo bed Made of durable 1 7/8 thick steel Powder coated in textured black to provide a uniform look with stock components Caution: Does NOT interfere with tail light visibility



REAR VIEW MIRROR

3D curved safety glass mirror provides excellent field of view. Durable textured block powder coating. Aluminum mounting with 43mm diameter clamp.

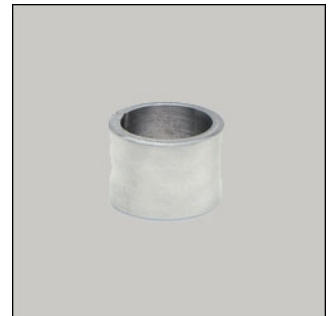

REDUCING BUSHING

When used with Hitch Ball Mount KAF138 or TX750-015, the Reducer Bushing is required, Kawasaki Genuine Accessories P/N: TLR36A



SKID PLATE - MID

Protects your drive chain and chassis with a durable brushed aluminum Kawasaki Genuine Skid Plate. Unlike the aftermarket plate, each genuine skid plate has been designed with precise ventilation holes and has been tested to prevent high engine temps during hard use or hot weather.

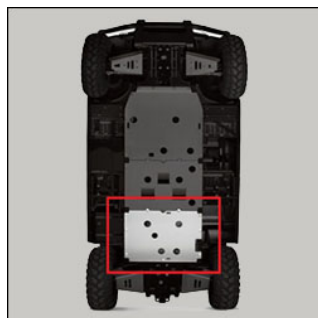

SKID PLATE - REAR

Protect your drive chain and chassis with a durable brushed aluminum Kawasaki Genuine Skid Plate. Unlike the aftermarket, each plate has been designed with precise ventilation holes and has been tested to prevent high engine temps during hard use or hot weather.



SPRINGS - HEAVY DUTY

Heavy duty Springs increase bottoming resistance when carrying a heavy load and or when heavy accessories such as a Kawasaki Genuine Cab Enclosure. Includes: two front springs and two rear springs. IMPORTANT NOTES: Direct replacement of stock springs.



STORAGE COVER

Protect your vehicle during storage with this premium cover. Durable grey polyester fabric. UV resistant to prevent fading. Features silk screened Kawasaki logos for a O.E.M appearance. Caution not for towing.



TAIL LIGHT GUARDS

Reduce the risk of impact, and ultimately the occurrence of unnecessary repairs. Powder coated in textured black to provide a uniform look with stock components.



TRAILER HITCH

* Heavy duty 2" steel drawbar with welded gusset * Pin and clip included . When used with Hitch Ball Mount KAF138 or TX750-015, the Reducer Bushing is required, Kawasaki Genuine Accessories P/N: TLR36A



TRAILER HITCH BALL

2" Chrome plated trailer hitch ball . Includes nut and lock washer. 3/4" diameter shank. 1 & 1/2" shank length. When used with Hitch Ball Mount KAF138 (for Mule) or TX750-015 (for Terxy), a reducer Bushing is required. Kawasaki Genuine Accessories part number TLR36A.



TRAILER HITCH CAP

* Plastic hitch cap with durable domed polyurethane coating * Custom Kawasaki logo * Fits most 2" receivers



TRAILER HITCH PIN 5/8 INCH

* Use with receiver-type trailer drawbars * Includes easy to install & remove hairpin clip * 5/8" Hitch Pin for 2" Drawbar * FOR REPLACEMENT ONLY



UNDERSEAT STORAGE BIN

Storage space is always a premium, especially when on the trail or at the job site. Adds additional storage securely and out of sight with this ease-to-access under seat storage bin. Mounts under front bench seat. Polyethylene construction with black powder coated steel brackets. Matching snap-on lid. Storage bin removes easily once installed. 22 litre storage capacity.



WINCH MOUNT

A Winch Mount is required when installing a WARN ProVantage or Vantage winch and droller fairlead to your vehicle. Four-bolt pattern allows for hassle-free installation of WARN products. IMPORTANT NOTES: Required when installing a winch